

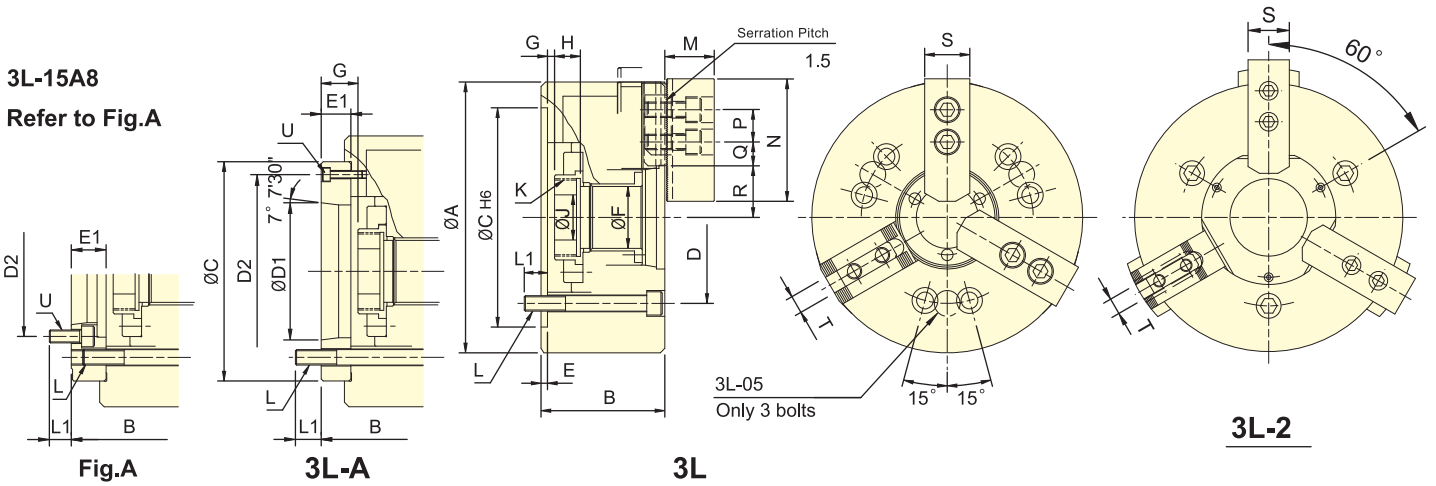

#### Application/customer benefits

- It's a CRANK type 3-jaw with the large through-hole, and extra long jaw stroke.
- Matching surfaces of all parts hardened, ground and lubricated directly.
- Construction of high rigidity and high clamping accuracy.
- J value is the hole diameter of blank draw nut, K is the maximum thread specification, and it could be customize.
- Patent numbers : Taiwan : PAT.207282 / China : PAT.ZL02284637.9

**3L-15A8**  
Refer to Fig.A



\* Subject to technical changes.

#### Specifications

Model	Plunger stroke (mm)	Jaw stroke (Dia.) (mm)	Chucking Dia. Max. (mm)	Chucking Dia. Min. (mm)	Max. D.B. pull kN (kgf)	Max. clamping force kN (kgf)	Max. speed min <sup>-1</sup> (r.p.m.)	I kg · m <sup>2</sup>	Weight (kg)	Matching cyl.	Max. pressure MPa (kgf/cm <sup>2</sup> )	
3L-205 A4	12	18	138	6	15.6(1590)	17.2(1750)	4200	0.019	7.2	8.0	TK-A533	2.3(23)
3L-206 A5	15	24	170	18	23.5(2400)	26(2650)	3600	0.063	13.5	15.3	TK-C646	2.7(27)
3L-208 A5	20	32	215	25	34.3(3500)	40.7(4150)	3000	0.18	24.1	27	TK-A853	2.8(28)
3L-208 A6	20	32	215	25	34.3(3500)	40.7(4150)	3000	0.18	24.1	25.2	TK-A853	2.8(28)
3L-210 A6	25	37.5	260	47	47.7(4870)	55.9(5700)	2400	0.35	39.5	46.5	TK-1075	3.3(33)
3L-210 A8	25	37.5	260	47	47.7(4870)	55.9(5700)	2400	0.35	39.5	45	TK-1075	3.3(33)
3L-212 A8	30	45	315	54	64.7(6600)	61(6220)	2100	0.827	67.3	70.5	TK-A1291	3.0(30)
3L-15 A8	35	52	385	50	84.3(8600)	68(6930)	1600	2.58	136	150	TK-1512	2.6(26)
3L-15 A11	35	52	385	50	84.3(8600)	68(6930)	1600	2.58	136	143	TK-1512	2.6(26)

#### Dimensions

Model	A	B	B	C	D	D1	D2	E	E1	F	G max.	G max.	G min.	G min.	H	J	K max.	L	L1	L1	M	N	P	Q max.	Q min.	R max.	R min.	S	T	U
3L-205 A4	135	65	76	110	82.6	63.51	96	4	15	32	1	16	-11	4	20	12	M40x1.5	3~M10	15	15	31	62	14	23	9.5	31	22	25	10	3~M6
3L-206 A5	170	84	97	140	104.8	82.56	116	5	18	45	6.5	24.5	-8.5	9.5	19	20	M55x2	3~M10	18	15	37	73	20	15.25	7.75	51	39	31	12	3~M6
3L-208 A5	215	96	114	170	133.4	82.56	104.8	5	23	52	7	30	-13	10	20	30	M60x2	3~M12	18	19	38	95	25	19.25	10.25	63.5	47.5	35	14	6~M10
3L-208 A6	215	96	114	170	133.4	106.38	150	5	23	52	7	30	-13	10	20	30	M60x2	3~M12	18	20	38	95	25	19.25	10.25	63.5	47.5	35	14	3~M6
3L-210 A6	260	108	130	220	171.4	106.38	133.4	5	25	75	8.5	33	-16.5	8	25	45	M85x2	3~M16	25	20	43	110	30	24.75	11.25	80	61.25	40	16	3~M8
3L-210 A8	260	108	121	220	171.4	139.72	190	5	18	75	8.5	26.5	-16.5	1.5	25	45	M85x2	3~M16	25	22	43	110	30	24.75	11.25	80	61.25	40	16	3~M8
3L-212 A8	315	125	138	220	171.4	139.72	190	5	18	91	15	33	-15	3	30	50	M100x2	3~M16	24	21	51	130	30	29.75	13.25	96.5	74	50	21	3~M8
3L-15 A8	385	150	177	300	235	139.72	171.4	6	33	120	12.5	45.5	-22.5	10.5	39	60	M130x2	6~M20	33	31	63	165	43	51.25	27.25	94.25	68.25	62	25.5	6~M16
3L-15 A11	385	150	166	300	235	196.87	260	6	22	120	12.5	34.5	-22.5	-0.5	39	60	M130x2	6~M20	33	31	63	165	43	51.25	27.25	94.25	68.25	62	25.5	3~M10

The dimensions and the specifications of 3L-A type are in the red data.