

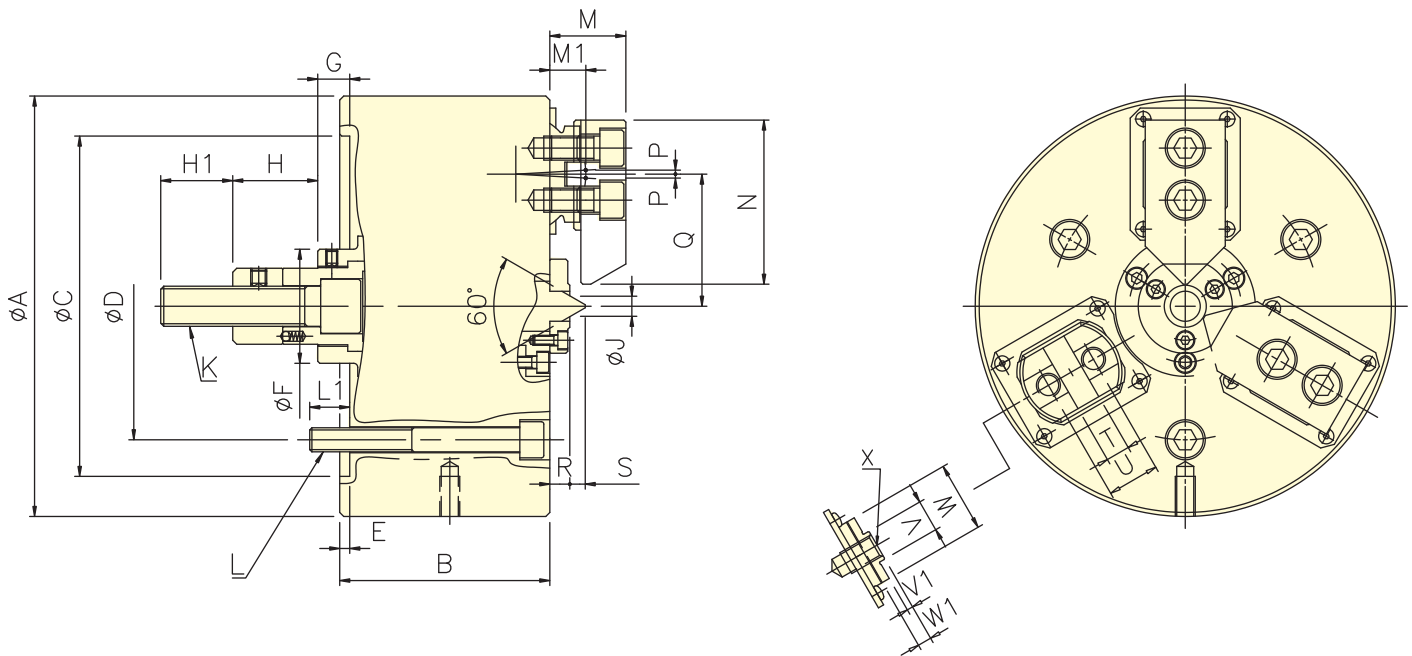

Application/customer benefits

- The workpieces compensation of eccentric is 2 mm, fixed position for the center thimble, swing and grasp the workpiece to three jaws.
- Suitable for such materials as the casting and forging to process.
- Special seal proof for dust and cutting fluid, it is more convenient when maintenance.
- Swing parts are to heat treatment hardened and ground for steel, in order to improve products service life.

SPECIAL PURPOSE



* Subject to technical changes.

Specifications

Model	Plunger stroke (mm)	Jaw stroke (Dia.) (mm)	Chucking Dia. Max. (mm)	Chucking Dia. Min. (mm)	Max. D.B. pull kN (kgf)	Max. clamping force kN (kgf)	Max. speed min ⁻¹ (r.p.m.)	I kg · m ²	Weight (kg)	Matching cyl.	Compensation (mm)
3R-08	20	8	65	18	19.6(1999)	53.0(5404)	2800	0.15	27	RK-100N	2
3R-10	25	10	90	22	29.4(2996)	67.7(6901)	2500	0.38	45	RK-125N	2

Dimensions

Model	A	B	C (H6)	D	E	F	Gmax.	Gmin.	H	H1	J	K	L	L1	M	M1	N	P	Q max.	Q min.	R	S	T (H7)	U	V	V1	W	W1	X
3R-08	210	105	170	133.4	5	57	26	6	42.5	36	10.4	M20x2.5	3-M12	20	38	18	82	2	68	64	10	7.7	12	26	16	3	35	7	M12
3R-10	254	115	220	171.4	5.5	64	36.5	11.5	25	39	15	M20x2.5	3-M16	22.5	40	19	102	2.6	82	78	10	11.3	15	32	18	3	40	7	M14