

Application/customer benefits

- Indexing operates during the spindle rotation, can a quick change between multiple working axes.
- Chuck of all parts hardened, ground and lubricated directly.
- Sealed against swarf, chips and coolant.
- Construction of high rigidity and high repeatability precision.
- Unique indexing system and of hydraulic system, with pressure detection device in chuck, high reliability.

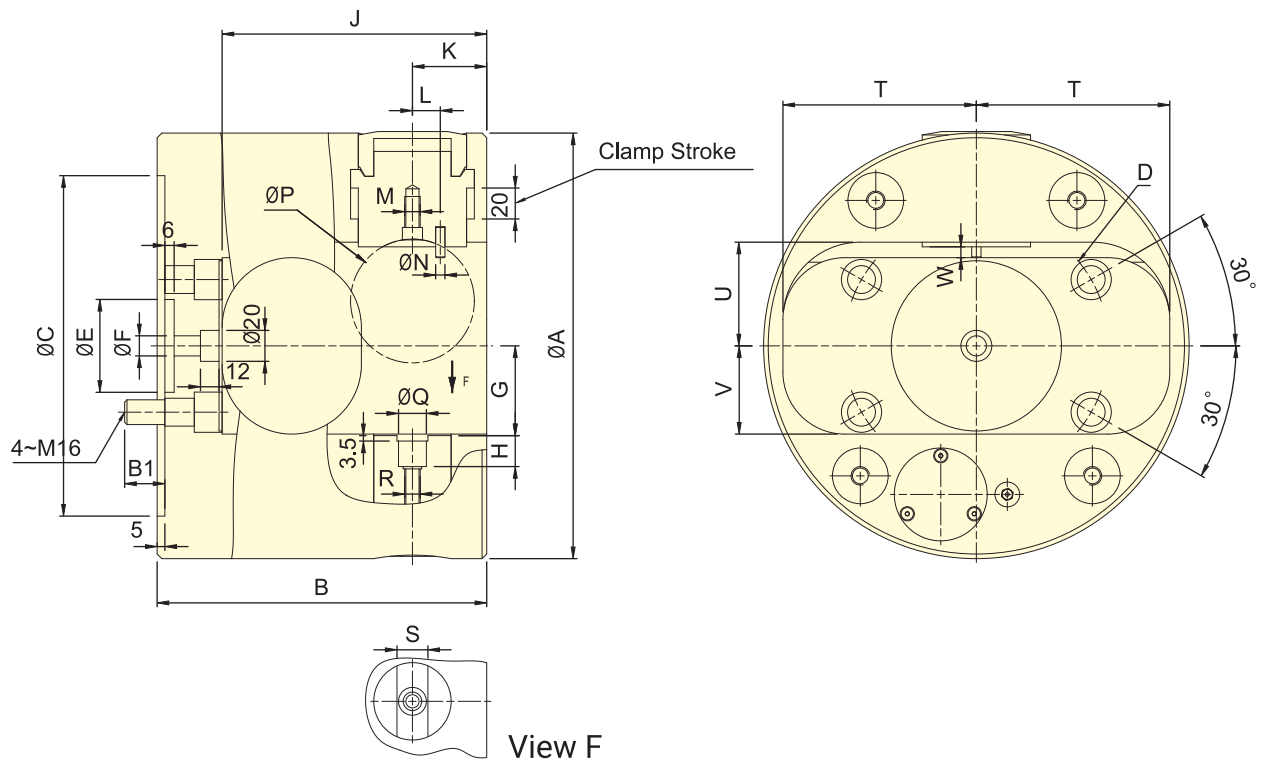

* Subject to technical changes.

Specifications

Model	Index Angle Deg	Jaw stroke (Dia.)(mm)	Chucking Area Dia Max. (mm)	Chucking Area Len Max. (mm)	Max. pressure (kgf/cm ²)	Max. clamping force kN(kgf)	Max. speed min ⁻¹ (r.p.m.)	I kg · m ²	Weight (kg)	ROTATING JOINT	Main Spindle Bore (mm)
* IS-254	8x45,4x90	20	65	160	45	19.5(1990)	2400	0.41	41	IS-315	86+0.1
* IS-275	8x45,4x90	20	80	220	45	25.4(2590)	2000	0.61	52	IS-315	86+0.1
* IS-315	8x45,4x90	20	100	230	45	25.0(2550)	1800	1.13	76	IS-315	86+0.1

Dimensions

Model	A	B	B1	C(H6)	D	E	F	G	H	J	K	L	M	N	P	Q(H7)	R	S(H7)	T	U	V	W
* IS-254	254	190	23	220	171.4	60	13	47.5	18	155	48	13	M8	5	40	18	M10	20	106	57	46.5	5.5
* IS-275	275	213	26	220	171.4	60	13	58	20	171	48	18	M10	6	80	18	M10	20	125	67	57	7
* IS-315	315	232	22	220	171.4	60	13	71	18.5	187	50	18	M10	6	75	24	M12	25	125	85	70	7.5

*model produced only by order.